

Swale House, East Street,
Sittingbourne, Kent ME10 3HT
DX59990 Sittingbourne 2
Phone: 01795 417850
Fax: 01795 417141
www.swale.gov.uk

ANNEX A



Making Swale a better place

Resident/Business

Please ask for: Brett O'Connell
Direct Line: 01795 417061
Fax: 01795 417477
E-mail: brettoconnell@swale.gov.uk
Our Ref:
Date: 3rd March 2014

Church Road, Eurolink, Sittingbourne – Proposed Double Yellow Lines

Dear Resident/Business Owner

A request was received from a business to investigate the possibility of parking restrictions in Church Road, Sittingbourne as per the enclosed plan.

Swale Borough Council was informed that vehicles parking near the entrance to units in the Church Road Business Centre created problems for deliveries by large vehicles.

The proposed restrictions will improve visibility and vehicle movements in this area.

If you would like to comment on the proposals then please fill out the enclosed comments form and state whether you object, support or are undecided. Please return the comments form by **Friday 21st March 2014**. The results of the consultation will be submitted to the Joint Transportation Board meeting in June 2014 for a recommendation.

Alternatively, you can e-mail your comments to brettoconnell@swale.gov.uk, please state whether you support or object to the proposals. If you would like to know the outcome of the consultation please contact me by email or on 01795 417061 after the closing date.

Yours Sincerely

Brett O'Connell

Brett O'Connell
Assistant Engineer



Are you registered to vote?
www.swale.gov.uk/all-about-voting



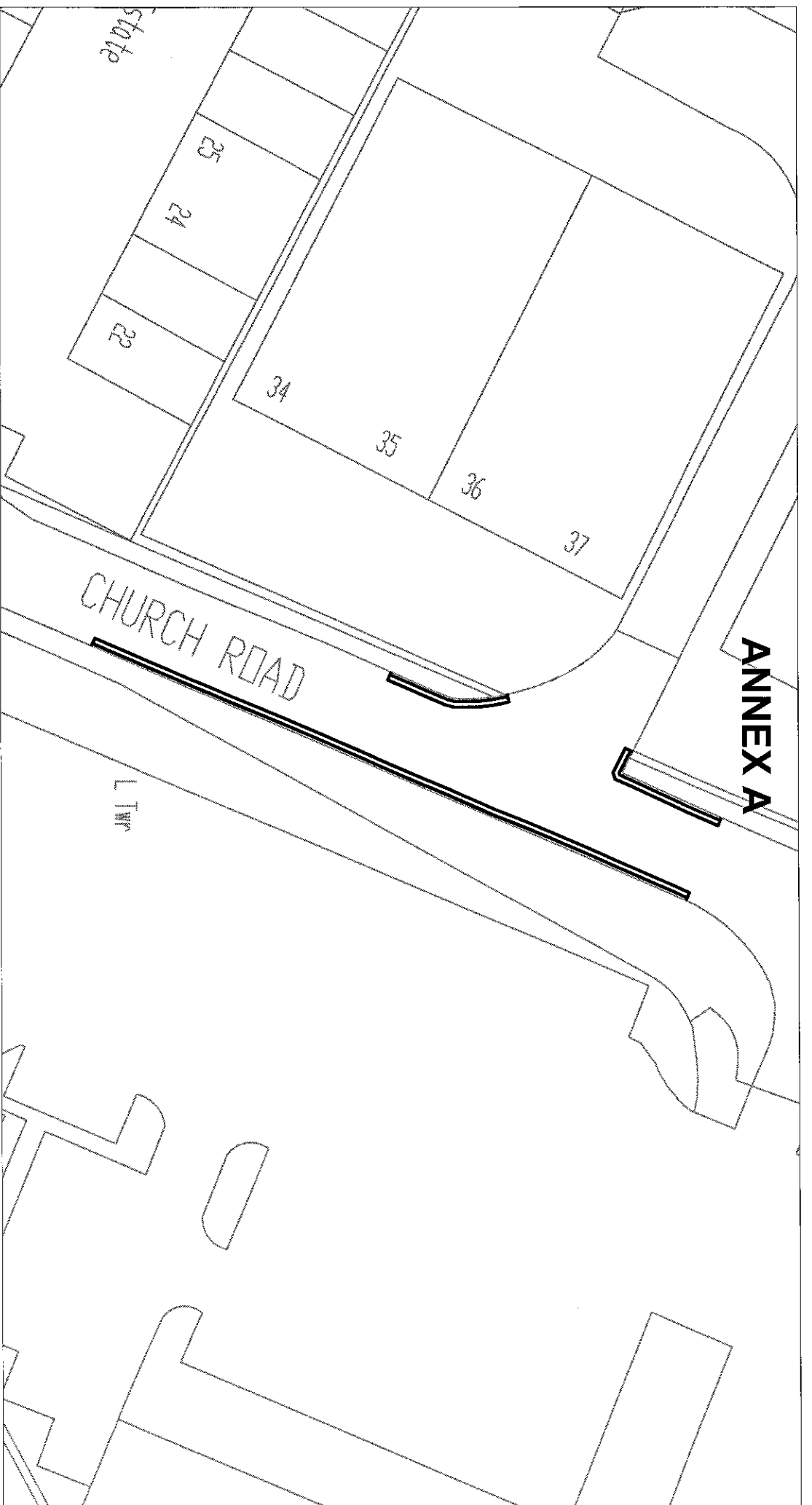

Key

Proposed Double Yellow Lines 

DRAWN	BOC
DATE	Jan 14
SCALE	N.T.S

Church Road, Eurolink Industrial Estate

ES/2738/151

No.Jesty's Stationery, Drefce (D) Crown copyright. Unauthorised reproduction infringes Crown copyright and may lead to prosecution or civil proceedings. Swale Borough Council, LN79655, 2001

